

### PLUMBERS INSTALLATION INSTRUCTIONS

#### Important Information

- \* Not suitable for gravity feed systems.
- \* Mixer is fitted with a flow regulated aerator insert. This low flow rate may not be suitable for connection to some Instantaneous Gas Water Heaters, some Tempering Valves, some Solar Water Heaters & some Thermostatic Mixing Valves. Check with the manufacturers of these products.
- \* Isolating stop taps are recommended to be fitted to the inlet connections. (Part No. 842018C - Mini cistern 1/4T).
- \* All pipework must be thoroughly flushed prior to installation, as foreign materials may block the flow regulating device and reduce the flow of water. **Note: Aerator insert housing must be retightened to prevent removal by hand.**

#### Installation

- 1) From fixing pack fit 'O'ring (16) into groove in underside of mixer base (8). Screw stud (9) into underside of mixer (8).
- 2) *Flexible Tail Mixer Connections:* Apply suitable lubricant to 'O'rings (15). Fit flexible tail (14) (with red indication) into inlet hole marked 'H' in underside of mixer body (8). Hand tighten the tail, ensuring the 'O'ring (15) has fully entered the sealing bore to provide a watertight joint. Fit other flexible tail (with blue indication) into remaining hole in a similar manner.
- 3) Insert the inlet connection end of each tail (14) through the hole in the deck. Place mixer over deck hole, ensuring hot water tail (14) is to the left and stud (9) is at the back. Fit gasket (10) and fixing plate (11) over stud (9) and screw on fixing nut (12). Align mixer body so that the handle (1) rotates at equal angles from left to right then tighten fixing nut (12).
- 4) *Flexible Tail Inlet Connections:* Connect the flexible tails (14) to the hot and cold isolating stop taps, hand tighten the fixing nut (13) until rubber cone contacts the sealing face of the connection end, then tighten a further one turn to provide a watertight joint.

**Important:** Flexible tails must not be kinked, twisted or in tension when installed. (Minimum Bend Radius:- 50mm)  
Do not install flexible tails where subject to ultra violet light.

#### Servicing Aerator Insert

- 1) Carefully remove aerator housing (17) from mixer spout (8), taking care not to damage the decorative finish.
- 2) Remove seal (19) & aerator insert (18) from aerator housing. Check that aerator housing is clean. Deposits of lime can be removed by washing in a vinegar solution.
- 3) Fit new aerator insert (18) into aerator housing (17) followed by seal (19) then screw assembly into mixer spout (8) and tighten securely (to prevent removal by hand).

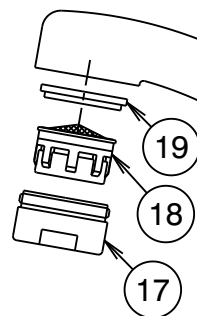

#### Replacing Cartridge

- 1) Turn off hot and cold water supplies at isolating stop taps.
- 2) Remove indicator plug (3). Using 2.5mm allen key (4) loosen screw (2) and remove handle (1). Remove cap (5) taking care not to damage the decorative finish. Unscrew nut (6) then lift out old cartridge (7).
- 3) Ensure inside face of mixer body (8) is clean. Check that seal is in position in base of new cartridge (7). Fit new cartridge (7) into mixer body, taking care that two lugs on base of cartridge (7) fit into mating holes in mixer body (8).
- 4) Screw on nut (6). **Important:-** Nut (6) should be tightened to a torque of 10 Nm.
- 5) Replace cap (5), tightening by hand. Fit handle (1) taking care that it is pushed fully onto cartridge stem, tighten screw (2) and replace indicator plug (3), position with red to the left.
- 6) Turn on isolating stop taps and check operation.

#### **IMPORTANT**

##### Pressure & Temperature Requirements.

- Hot and cold water inlet pressures should be equal.
- Inlet pressure range : 150-1000 kPa  
New Regulation:- 500 kPa maximum static pressure at any outlet within a building. (Ref. AS/NZS 3500.1)
- Maximum hot water temperature : 80°C.

##### Deck Requirements

- Deck thickness : 45mm maximum
- Tap body holes (in deck) : Ø34-36mm

