



CAROMA

# SMART COMMAND Concentrator

Intelligent Bathroom system integration  
with existing BMS or Cloud Based  
Management System

CI/SfB	(74.1)	g3
Date	June 2018	

Supersedes all previous issues

# 13.02.1





# SMART COMMAND Concentrator (MQTT - BACnet IP)



- THE CONCENTRATOR IS A MQTT / BACNET INTERFACE FOR THRID PARTY BMS SYSTEMS.
- CONSOLIDATES DATA FROM MULTIPLE GATEWAYS TO PROVIDE A SINGLE ACCESS POINT.
- CONVERTS MQTT MESSAGES INTO NATIVE BACNET IP.
- BUILT IN, UPGRADABLE FIRMWARE FOR CONFIGURATION OF CONCENTRATOR
- ONE CONTENTRATOR PER BMS SYSTEM IS REQUIRED TO WORK WITH ALL LINKED FIXTURES AND GATEWAYS
- COMPLETE WITH POWER SUPPLY AND MOUNTING HARDWARE

## Part Number

410101

Caroma Smart Command Concentrator MQTT - BACnet

<b>Electronics:</b>	Supply voltage to the system is 240V AC 50Hz. Operating current 5 volts DC.
<b>Installation:</b>	VESA, DIN-Rail, Side/Wall Mounting. RJ45 Ethernet Cabling
<b>Dimensions:</b>	All dimensions are in millimetres and are subject to normal manufacturing tolerances. Caroma pursues a policy of continuing improvement in design and performance of its products. The right is therefore reserved to vary specifications without notice.

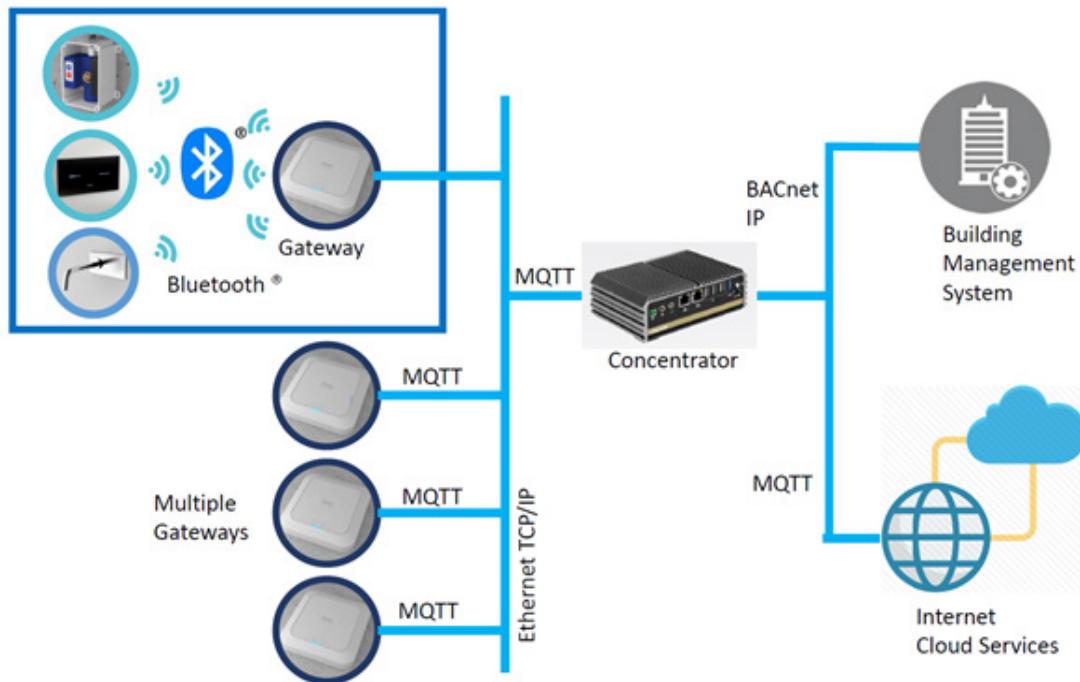

Figure 1: Smart Command - System View

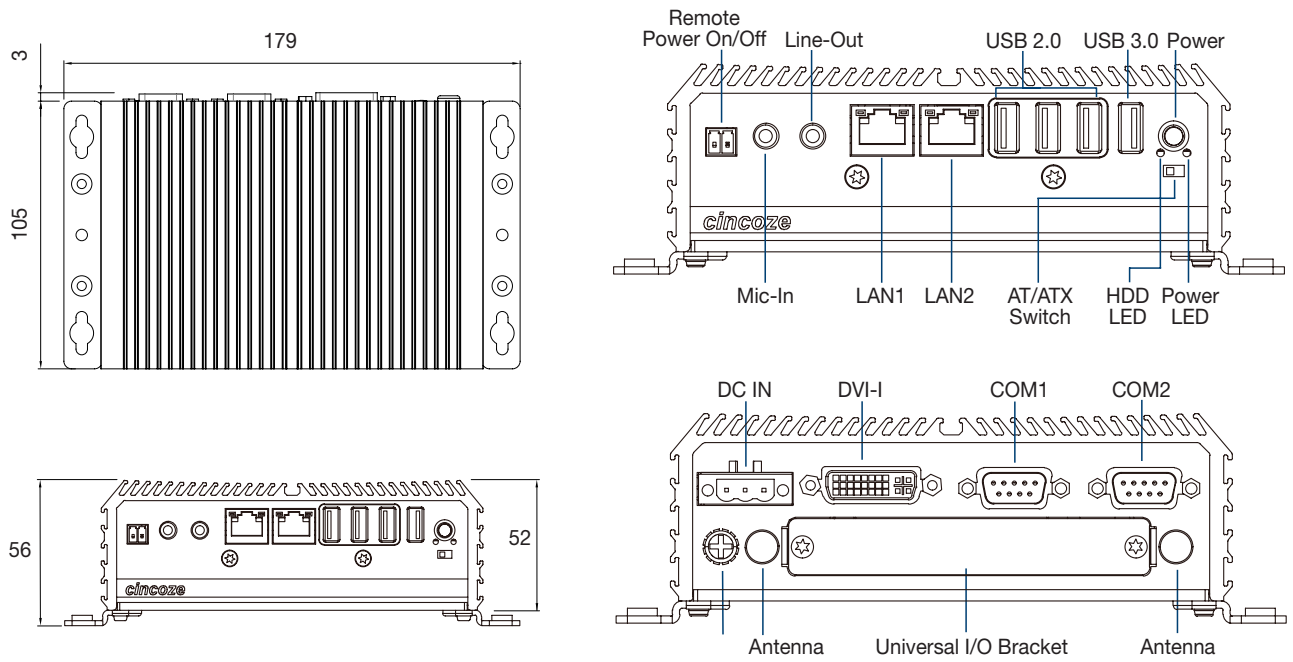

Figure 2: Product Assembly

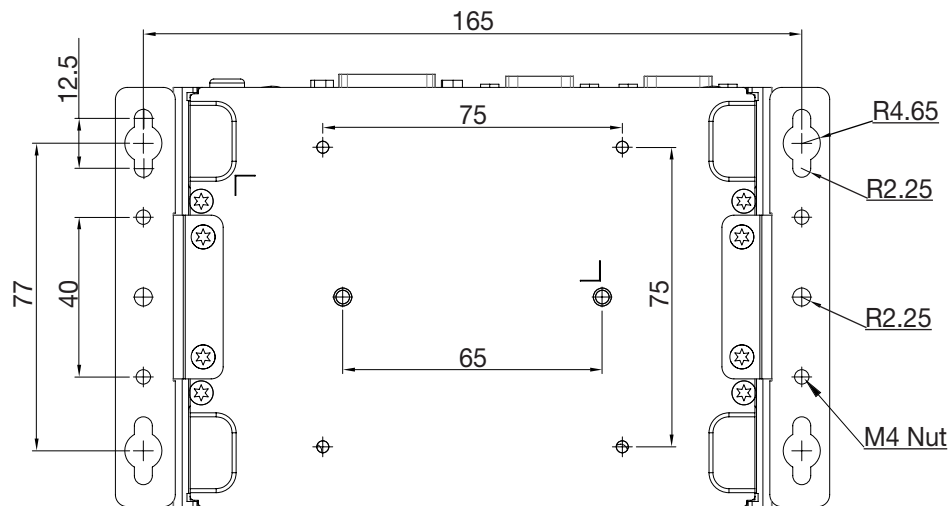

Figure 3: Wall mounting specifications

<b>Processor</b>	On-board Intel Atom
<b>Memory</b>	8G
<b>OS</b>	Customised Debian Linux distribution.
<b>Protocols</b>	MQTT, BACnet IP
<b>Concentrator Dimensions</b>	H: 56mm x L: 150mm x D: 105mm
<b>Concentrator Weight</b>	0.86 kg
<b>Power Requirements</b>	9-48V DC: 240VAC Power Adaptor Supplied
<b>Power Adaptor</b>	12V/5A 60W
<b>Ambient Temperature</b>	-25°C ~ 70°C
<b>LAN Ports</b>	Dual Intel I210-AT GbE
<b>USB Ports</b>	1 x USB 3.0 & 3 x USB 2.0 (Type-A)
<b>RS Ports</b>	2 x RS-232/422/485 with Auto Flow Control, D89
<b>EMC Compliance</b>	EN 301 489-1 V2.1.1, EN 300 328 V2.1.1, EN623111, EN62368-1: 2014, AS/NZS CISPR 32:2015 (ITE Class B)
<b>Electrical Safety Compliance</b>	IEC 60950-1, UL 60950-1, CSA C22.2 60950-1
<b>Complies with EC Directives</b>	RoHS2 Directive 2011/65/EU, Waste Electrical and Electronic Equipment (WEEE) Directive 2002/96/EC, Registration, Evaluation, Authorisation and Restriction of Chemicals (REACH) Directive, Conflict Minerals Directive
<b>Packaging</b>	Dimensions: H: 160 mm x L: 200 mm x D: 100 mm Weight: 1 kg Quantity: 1