

Caravelle Care

Accessible Application Installations

A specialised seat available in single or double flap versions designed for persons with ambulant disabilities. Featuring solid stainless steel hinges, rotatable buffers for extra stability during side way transfers. Blind Fixings standard.

Colours: White, Blue or Grey (single flap).

Options	Code
Single Flap	322012
Double Flap	322020

Seat section

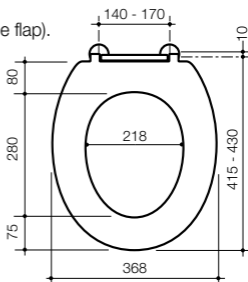

Caravelle Commercial

A medium weight seat with robust metal hinges and fully adjustable blind fixing.

Colours: White only.

Options	Code
Standard with Stainless	
Steel hinges	301031

Seat section

