

# Venecia

## Vitreous China Semi Recessed Vanity Basin

Basin Size: 500mm x 460mm (nominal)



Chrome waste shown above supplied as standard late 2010

The Venecia Basins feature clean lines and smooth finishes for a sleek look and fuss-free maintenance. The basin is a cost-effective way to bring contemporary style to your bathroom. This basin is suitable for domestic, commercial and disabled applications (refer to Compliant Product section).

- Tap Holes:** Basin available in: no taphole Code No.W40100; 1 tap hole Code No.W40101, 3 tap holes Code No.W40103.
- Waste Outlet:** Flush fitting plug and waste suitable for a 40m trap connection included. Alternative waste options are available —Vandal Resistant Flush Fitting Plug and Chrome Waste Code No.687141, Covered Plug and Waste Code No.687142 and Vandal Resistant Covered Chrome Plug and Waste Code No.687143.
- Bowl Capacity:** 5 litres to overflow.
- Overflow:** Overflow available only.
- Fixing:** **Bracket** – Supplied. Recommended for domestic and general commercial use. The basin must be sealed to the top and front surface of the counter with an acetic cured silicone sealant. **Epoxy type glues must not be used.**
- Colours:** White only.
- Dimensions:** Dimensions are in mm and subject to normal manufacturing tolerances. The manufacturer reserves the right to alter specifications without notice.

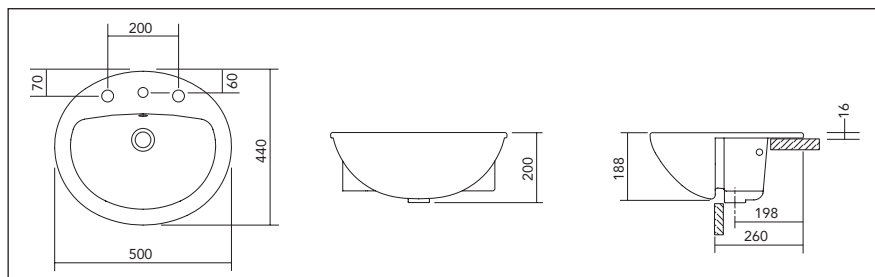

# Symphony

## Vitreous China Semi Recessed Vanity Basin

Basin Size: 500mm x 432mm (nominal)



Chrome waste shown above supplied as standard late 2010

The Symphony semi recessed basin offers a traditional design whilst complementing your benchtop and tapware selection. This basin is suitable for domestic, commercial and disabled applications (refer to Compliant Product section).

- Tap Holes:** Basin available in: 1 tap hole Code No.CM3015W, 3 tap holes Code No.CM3035W
- Waste Outlet:** Flush fitting plug and waste suitable for a 40m trap connection included. Alternative waste options are available —Vandal Resistant Flush Fitting Plug and Chrome Waste Code No.687141, Covered Plug and Waste Code No.687142 and Vandal Resistant Covered Chrome Plug and Waste Code No.687143.
- Bowl Capacity:** 4.1 litres.
- Overflow:** Overflow available only.
- Fixing:** **Bracket** – Supplied. Recommended for domestic and general commercial use. The basin must be sealed to the top and front surface of the counter with an acetic cured silicone sealant. **Epoxy type glues must not be used.**
- Colours:** White only.
- Dimensions:** Dimensions are in mm and subject to normal manufacturing tolerances. The manufacturer reserves the right to alter specifications without notice..

