

Caroma®

Cube Invisi II

4.5/3 litre Dual Flush Toilet Suite with
Cube Wall Hung Box Rim Vitreous China Pan
and Invisi II Cistern for Inwall, Under Counter,
Induct or Inceiling applications

CI/SfB	(74.1)	g3
Date	October 2015	

Supersedes all previous issues

3.43.1

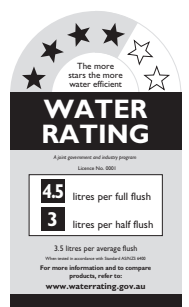

Caroma® Cube Invisi II

**4.5/3 litre Dual Flush Toilet Suite with
Cube Vitreous China Wall Hung Box Rim Pan
and Invisi II Cistern for Inwall, Under Counter,
Induct or Inceiling applications**



Cube Invisi II wall hung toilet suite is suitable for inwall, under counter, induct, and in ceiling applications. Featuring smooth sides and concealed plumbing fittings with projection from wall of 550mm. Multiple button options are available to suit domestic and commercial applications. Concealed cistern and plumbing deliver space savings, easy cleaning and matched performance.

- Pan:** **Cube** 4.5 litre full flush wall hung box rim wall hung pan.
- Traps:** P-trap only.
- Cisterns:** **Invisi II** cistern – suitable for inwall, under counter, induct and in ceiling applications. For push button and access plate (not supplied) options see 6.15.1.
- Fixing:** **Pan** – fixing bracket is supplied with the toilet suite, options include –
Inwall bracket for concrete floors and stud walls, (D402) suitable for inwall, induct and in ceiling applications.
Inwall bracket for structural brick walls (D788).
Under Counter bracket for concrete floors (D403).
Note: The bracket systems are suitable for installation only where non compressible wall materials are used.
Cistern – the cistern and bracket for under counter or in inwall Invisi II systems are pre-assembled and are supplied with the flush pipe and a waste pipe suitable for installation in a 90mm cavity wall. Structural brick wall systems require the cistern to be fixed to the wall. For in wall applications with raised height cisterns an extension kit is provided with the kit.
- Seats:** The **Cube** soft close toilet seat is provided as standard with the Cube suite. See chapter 5.01 SEATS of the Caroma Technical Manual for further details.
- Colours:** White only.
- Installation:** The installation of the toilet suite shall be in accordance with the normal minimum drainline grade requirements in AS/NZS 3500.2.
- Dimensions:** All dimensions are in millimetres and are subject to normal manufacturing variations. Caroma pursues a policy of continuing improvement in design and performance of its products. The right is therefore reserved to vary specifications without notice.

Cube Invisi II Wall Hung Suite Inwall/Under Counter Installations

Cube Invisi II Wall Hung Toilet Suites with Seat: Code No.

4.5/3 litre Back Inlet Internal overflow Inwall/Induct/Inceiling Suite	717100
Under Counter Suite	735100
Structural Wall Suite	771500

Button options: see 6.15.1

Inwall Installation

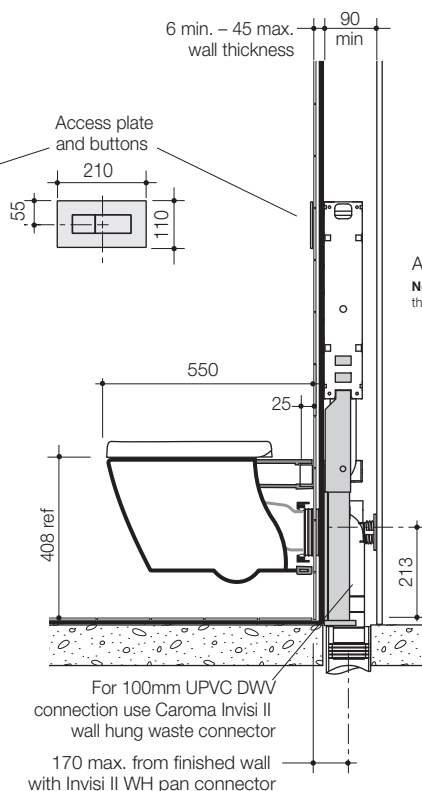
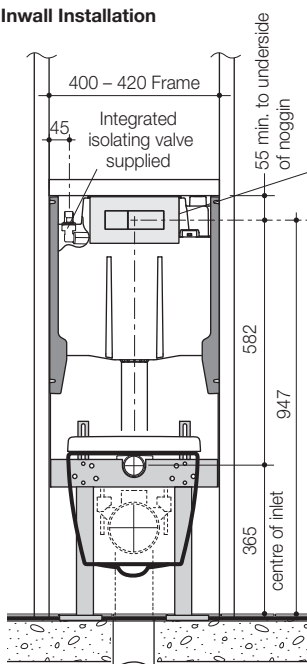

Under Counter Installation

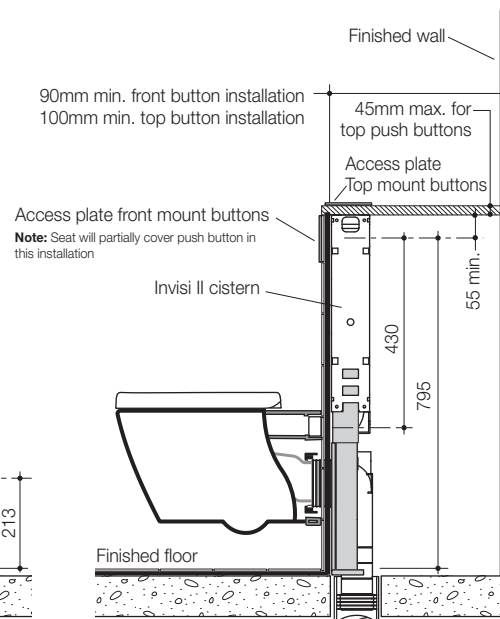

Note: access to cistern internals can be achieved through either front or top mount button plate option.