

PLUMBERS INSTALLATION INSTRUCTIONS

Important Information

- * Not suitable for gravity feed systems.
- * Mixer is fitted with a 6 L/min flow regulator (20).
This low flow rate may not be suitable for connection to some Instantaneous Gas Water Heaters, some Tempering Valves, some Solar Water Heaters & some Thermostatic Mixing Valves.
Check with the manufacturers of these products.
- * Isolating stop taps must be fitted to the hot & cold water supply connections. (Part No. 842018C - Mini cistern 1/4T)
- * All pipework must be thoroughly flushed prior to installation, as foreign materials may block the flow regulating device and reduce the flow of water.
Note: Aerator insert housing must be retightened to prevent removal by hand.

Installation

- 1) From fixing pack fit 'O'ring (10) into groove in underside of mixer body (9).
- 2) **Flexible Tail Mixer Connections:** Apply suitable lubricant to 'O' rings (13). Fit flexible tail (14) (with red indication) into hole marked with a Red Dot in underside of mixer body (9). Hand tighten the tail, ensuring the 'O'ring (13) has fully entered the sealing bore to provide a watertight joint. Fit other flexible tail (with blue indication) into remaining hole in a similar manner.
- 3) Insert the inlet connection end (15) of each flexible tail (14) through the hole in the deck. Place mixer over deck hole, fit gasket washer (11) over threaded tail of mixer body (8) then screw on fixing nut (12). Position mixer as shown, with **caroma** marking on base facing towards the front, then tighten fixing nut (12) using a suitable tool.
- 4) **Flexible Tail Inlet Connections:** Connect the flexible tails (14) to the hot and cold isolating stop taps, hand tighten the connecting nut (15) until rubber cone contacts the sealing face of the connection end, then tighten a further one turn to provide a watertight joint.
Important: Flexible tails must not be kinked, twisted or in tension when installed. (Minimum Bend Radius:- 50mm)
Do not install flexible tails where subject to ultra violet light.

IMPORTANT	
Pressure & Temperature Requirements.	
• Hot and cold water inlet pressures should be equal.	
• Static inlet pressure range : 150- 1000 kPa New Regulation:- 500 kPa maximum static pressure at any outlet within a building. (Ref. AS/NZS 3500.1- 2003, Clause 3.3.4)	
• Maximum hot water temperature : 80°C.	
Deck Requirements	
• Deck thickness : 45mm maximum	
• Tap body hole (in deck) : Ø34- 36mm	

Replacing Cartridge

- 1) Turn off hot and cold water supplies.
- 2) Carefully remove plug (4) before using a 2.5mm allen key (3) to loosen grub screw (2) and remove handle (1). Remove cap (5) taking care not to damage the decorative finish. Unscrew nut (6) then lift out old cartridge (7).
- 3) Ensure inside face of mixer body (9) is clean. Check that seal (8) is in position in base of new cartridge (7). Fit new cartridge (7) into mixer body (9), taking care that two lugs on base of cartridge (7) fit into mating holes in mixer body (9).
- 4) Screw on nut (6). **Important:** Nut (6) should be tightened to a torque of 10 Nm.
- 5) Replace cap (5), tightening by hand. Fit handle (1) taking care that it is pushed fully down, then tighten grub screw (2). Replace plug (4) taking care not to damage the decorative finish.
- 6) Turn on water supplies and check operation.

Servicing the Flow Regulator

If necessary, the flow regulator (20) can be accessed as follows:

- 1) Remove screw (16) using 3mm allen key and carefully remove swivel outlet (19) from mixer body (9). Remove retainer (18) from groove in spigot. If required, flow regulator (20) can be extracted from spigot using a small hooked tool. Ensure flow regulator (20) is clean and free of blockages.
- 2) When replacing, ensure flow regulator (20) is bottomed in bore in spigot of swivel outlet (19). Place retainer (18) in groove of spigot, then carefully insert the spigot of swivel outlet into the mating hole in the mixer body (9), ensuring 'o' rings are well lubricated and that the hole in the retainer (18) aligns with the side hole in the mixer body. Replace screw (16) and tighten.

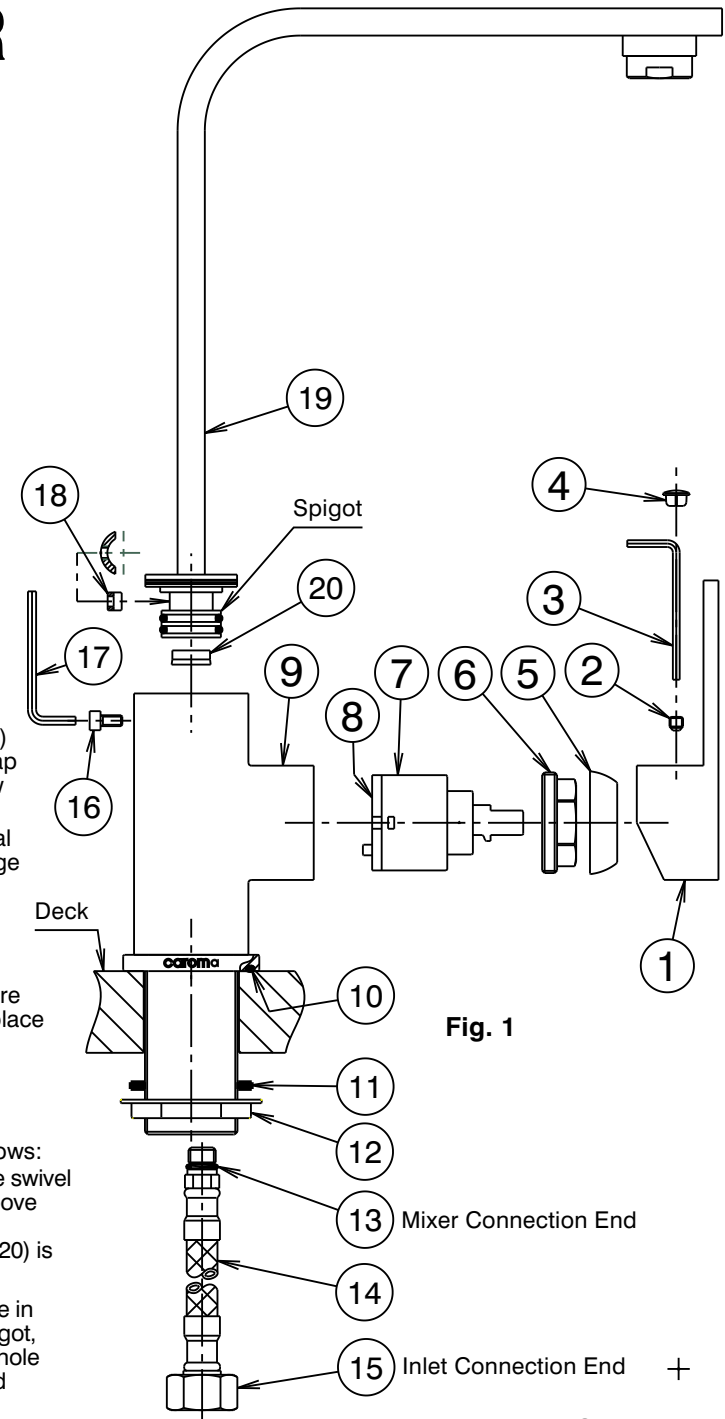

Fig. 1