



EPIC BLOC (PROGRESSIVE) BATH/SHOWER MIXER WITH DIVERTER

PLUMBERS INSTALLATION INSTRUCTIONS

Important Information

- * Brazed connections should NOT be made directly onto the mixer, as excessive heat will cause permanent damage.
- * All pipework must be thoroughly flushed prior to installation.
- * Final install must be checked at rough-in stage (step 1).
- * The in-wall range (base to wall face) is non-standard.
- * This mixer accommodates inwall depth from 65 - 75mm. For installations with less than 75mm the handle inserts (15) & (7) must be cut by using spacer (5) as a template, (Step 3 & Fig.4.)

Installation (Fig. 1 - 4)

- 1) Fit mixer body (17) onto a suitable mounting plate or noggin in the wall and secure using screws (not supplied) through the holes in its base. When facing the mixer, the connections should be as follows:
Hot water inlet connection 'H' to the left.
Cold water inlet connection 'C' to the right.
Outlet to shower 'S', vertically upwards.
Outlet to bath 'B', vertically downwards.
Check all connections for leaks and mixer for correct operation.
Important :
* To avoid damaging the decorative finish, do not remove the protective sleeves until installation has been completed.
* Mixer body (17) must be installed square to wall/tile face to ensure that wall cover plate (9) aligns with tile joints.
- 2) Pass the sleeve (8) through the cover plate (9) & 'O'Ring (9b), place the cover plate (9) over the plastic inserts (7 & 15) then screw sleeve (8) partially into the thread of nut (10) on mixer body (17). Pass the diverter sleeve (14) through the cover plate & 'O'Ring (9c) & screw into diverter nut (16). Carefully tighten the sleeve (8) & diverter sleeve (14) equally to fully compress the foam seal (9a) against the wall/tile face, taking care not to damage the decorative finish. **Important:** The cut-outs in the diverter sleeve (14) must be in horizontal alignment when the sleeve is tightened against the wall cover plate (Fig.1).
- 3) Using the handle spacer (5) as a template, place the flat side of the spacer against the front surface of the sleeve (8) & scribe a line around the plastic insert (7) as shown (Fig.4). Now place the flat base of the spacer against the front surface of the diverter sleeve (14) & scribe a line around the plastic insert (15) as shown. Carefully cut the plastic inserts (7 & 15) along the marked lines (if required) and remove any burrs.
- 4) Rotate the plastic insert (7) anticlockwise to the stop position. Slide the handle spacer (5) onto the plastic insert (7) until the spacer rests against the sleeve (8). Fit handle (1) onto insert (7), with the red/blue markings as shown (Fig.3), then

IMPORTANT	
Pressure & Temperature Requirements.	
•	Hot and cold water inlet pressures should be equal.
•	Static inlet pressure range : 150 -1000 kPa New Regulation :-500 kPa maximum static pressure at any outlet within a building. (Ref. AS/NZS 3500.1)
•	Maximum hot water temperature : 80°C.
Installation Requirements.	
•	The installing plumber is responsible for waterproofing all penetrations for Taps in Shower areas at installation by a proprietary flange system or a sealant. (Ref AS3740)

tighten grub screw (2). Fit plug (4) taking care not to damage the decorative finish.

- 5) Rotate the plastic insert (15) anticlockwise to the stop position. Slide the hexagonal washer (13) onto the plastic insert (15) until the washer rests against the diverter sleeve (14). Fit diverter knob (12) onto insert (15) with the position marking vertically up as shown (Fig.3). Rotate the knob (12) a quarter turn clockwise (position marking indicating to the right) and depress the knob until it bottoms and there is a small gap between the knob & the cover plate (9). Now rotate the knob (12) clockwise to the stop. The position marking is now indicating the bath position (vertically down). Rotating the knob anti-clockwise to the stop will select the shower position (vertically up).
- 6) Turn on Hot and Cold water supplies and check operation.

Replacing Cartridge (Fig. 1, 2 & 3)

- 1) Turn off hot and cold water supplies.
- 2) Carefully remove plug (4) before using a 2.5mm allen key (3) to loosen grub screw (2) and remove handle (1) and handle spacer (5). Undo screw (6) and remove insert (7) from old cartridge spindle. Rotate the cartridge knob (12) midway between bath & shower (position marking horizontal to the right) & pull the knob (12) to remove. Take out the hexagonal washer (13). Unscrew sleeve (8) & diverter sleeve (14) and remove cover plate (9), taking care not to damage the decorative finish. Unscrew retaining nut (10) (32mm A/F) then lift out old cartridge (11).
- 2) Ensure inside face of mixer body (17) is clean. Check that seals are in position in base of new cartridge (11). Fit new cartridge (11) into mixer body (17), taking care the lug on base of cartridge (11) fits into mating hole in mixer body (17). Screw on nut (10). **Important:** Nut (10) should be tightened until solid. Rotate the cartridge (11) spindle anti-clockwise to the stop position then fit insert (7) ensuring the flat sides of the insert are in horizontal/vertical alignment. Small adjustments can be made to the alignment by loosening nut (10) and rotating the cartridge slightly before re tightening the nut. Retain the insert (7) to the spindle using screw (6). Replace the cover plate (9) (see installation step 2). To replace handle (1) go to step 4 (Installation). To replace diverter knob (12) go to step 5 (Installation).
- 3) Turn on water supplies and check operation.

Side cut-outs must be orientated horizontally before fitting the Diverter knob.

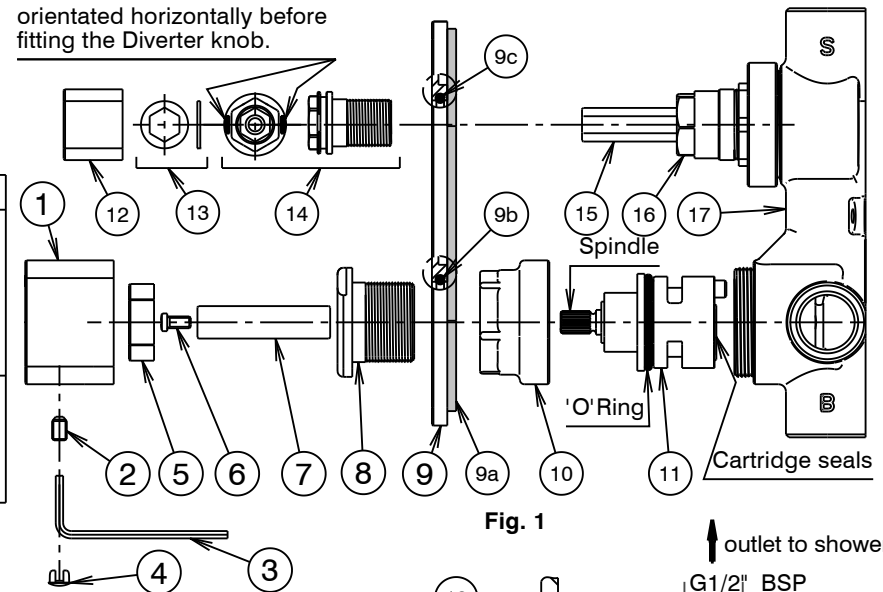

Fig. 1

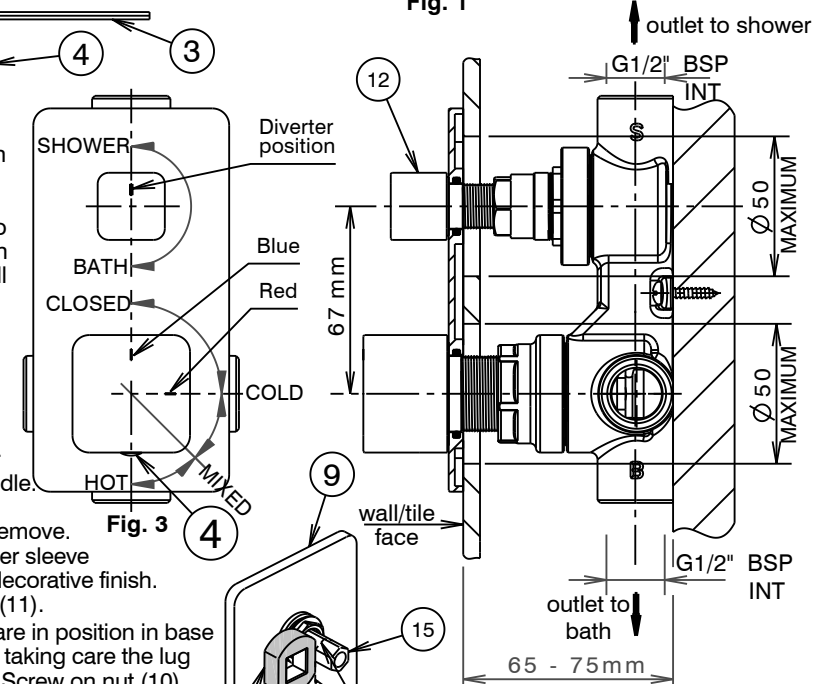

Fig. 2

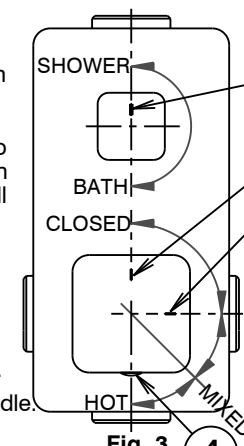

Fig. 3

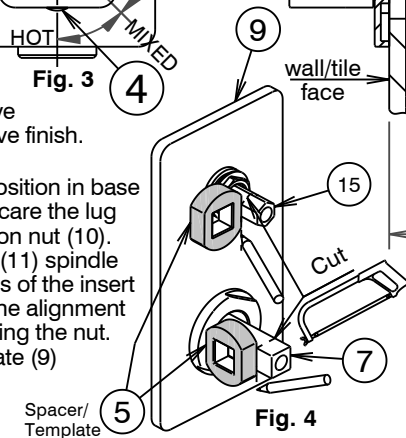

Fig. 4